

Artistic Perspective - Schell scheme booth

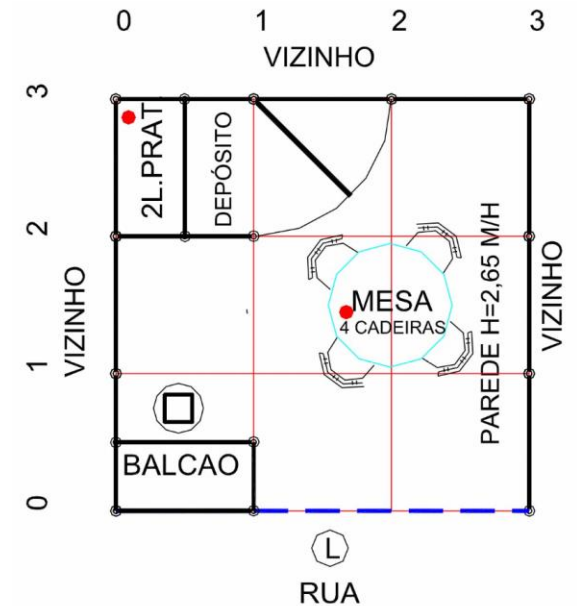
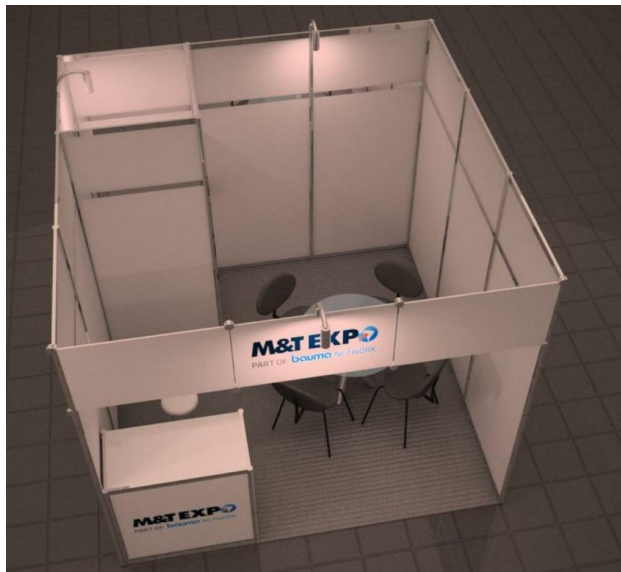

Descriptive - Schell scheme booth

General floor

The general floor will be covered with graphite carpet, only in the assembly area.

Walls

The walls and partitions of the stand will be assembled using white ts panels, under sleepers and anodized aluminum uprights. 2.65m / h walls

Ceiling

We will make an open pergola and enough to lock the walls.

Forehead

We will execute a standardized forehead with the application of a logo on a forehead in ts with lighting and a 220 watt spot.

Lighting / sockets

For lighting we will use luminaires every 3m² and we will put 01 sockets on each stand.

Visual communication

We will apply 01 logo on the front panel with front lighting and 01 logo on the counter.

Exhibition area

For each stand: 01 table with 4 chairs (each 12m²) upholstered and a counter with front logo;

Deposit

A deposit of 1 x 1 will be provided, with 2 flights of shelves in French hand, according to the project

Other items included

ART (technical liability note)

Fire extinguisher

Mandatory taxes included, energy, cleaning, city hall.